

BRINKS® EZ-N-STALL™ CLIP INSTRUCTIONS

CAUTION: THIS PRODUCT MUST BE INSTALLED IN ACCORDANCE WITH THE APPLICABLE INSTALLATION CODE BY A PERSON FAMILIAR WITH THE CONSTRUCTION AND OPERATION OF THE PRODUCT AND THE HAZARDS INVOLVED.

WARNING – TURN OFF THE POWER AT THE FUSE/BREAKER BOX PRIOR TO BEGINNING INSTALLATION.

- Do not connect or disconnect the luminaire under load.
- Do not reuse any connectors from a previous installation.

STEP 1:

- Using the Mounting Bar Screws, install the Mounting Bar to a grounded junction box rated for wet locations.

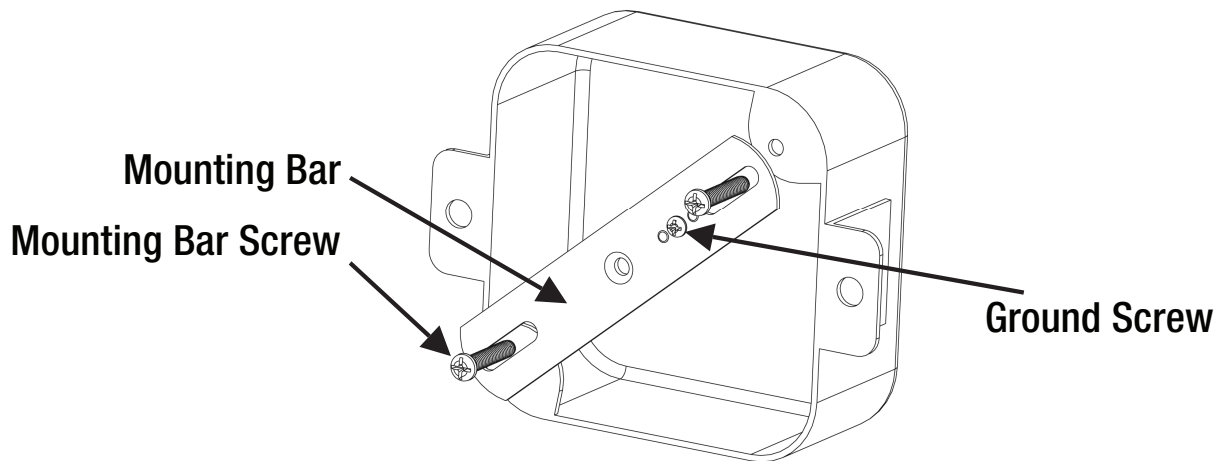

STEP 2:

- Using the Wire Connectors, connect the house wires to the matching colored wires on the EZ-N-STALL™ Connector.
- Connect the green wire (ground) from the EZ-N-STALL™ Connector to the green (or copper) wire from the junction box. If there is no green (or copper) wire from the junction box, the connect the green wire from the EZ-N-STALL™ Connector to the ground screw on the mounting bar.
- Connect the black wire from the EZ-N-STALL™ Connector to the black wire from the junction box.
- Connect the white wire from the EZ-N-STALL™ Connector to the white wire from the junction box.

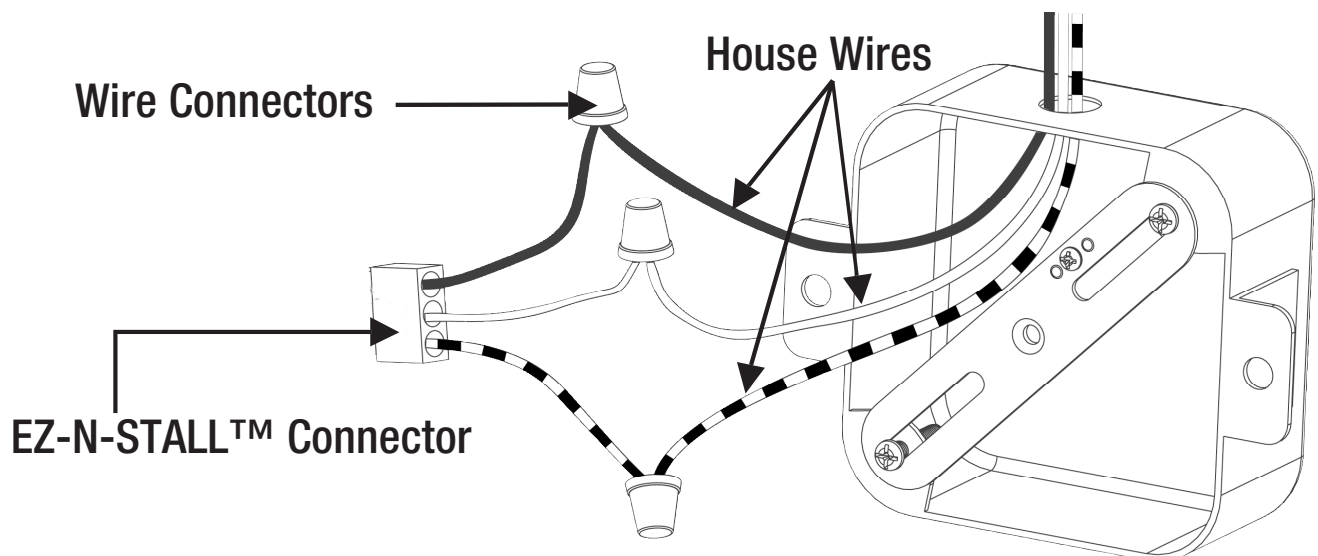

STEP 3:

- Push EZ-N-STALL™ Connector into EZ-N-STALL™ Clip and place onto mounting bar.

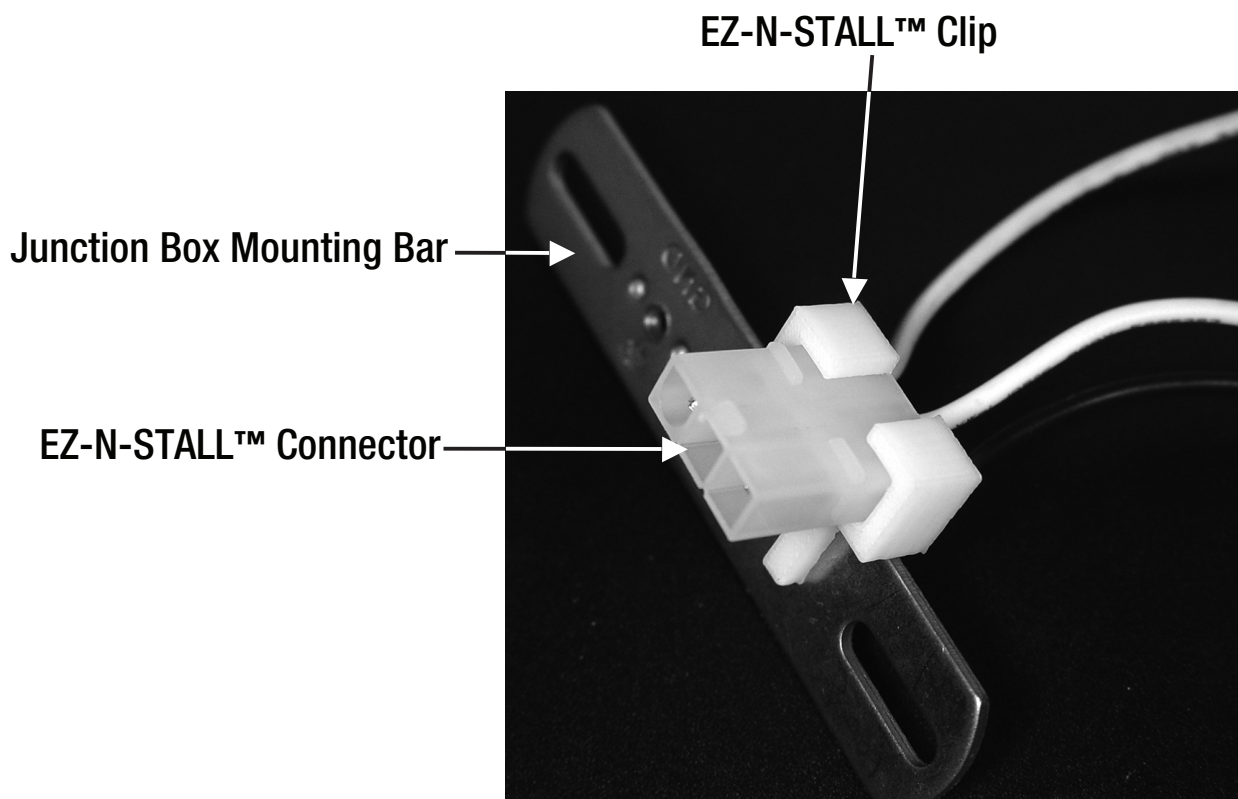

STEP 4:

- Plug EZ-N-STALL™ Connector attached to fixture into EZ-N-STALL™ Connector clipped onto the junction box mounting bar.

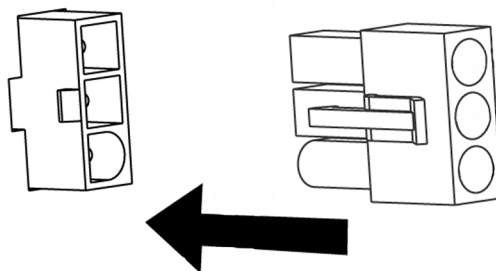

STEP 5:

- Continue with installation as outlined in instructions.

For information on a Brink's Home Security® system installation, please call 1-800-847-0689.

Brink's trademark and copyright works are used with permission.