

Congratulations on your purchase of a Brinks outdoor Coach Lantern. You have purchased a safe, dependable, easy-to-install lighting system. With the built-in motion sensor and photocell, the Coach Lantern can be set to turn on automatically from dusk till dawn or set to be activated only when motion is detected in the evening. For added security, the amount of time the light is on can be easily adjusted.

WHAT'S INCLUDED:

- A - Coach Lantern (1)
- B - Lantern Cover (1)
- C - Mounting Crossbar (1)
- D - Wire Nuts (3)
- E - Mounting screws (4)
- F - Optional Decorative Torchiere (Tail Piece) and Mounting Hardware (1 Set)

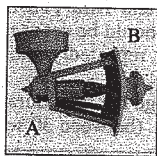

IMPORTANT SAFETY INFORMATION

- BE SURE POWER IS TURNED OFF AT THE MAIN POWER PANEL OR FUSE BOX BEFORE INSTALLING OR REPLACING THE FIXTURE AND/OR WHEN REPLACING THE BULB.
- This fixture is for outdoor use only.
- If you are not familiar with electrical wiring, it is recommended you secure services of a qualified electrician who can assure this installation meets local, state, and national codes.
- The electrical system and the method of connecting the fixture to the system must be in accordance with local, state, and national electrical codes.
- This fixture is to be connected to a 120 Volts, 60 Hz power source. Connecting to a different power source may create a hazard and will void the warranty.
- This fixture should be mounted to a grounded junction box marked for use in wet locations.
- Do not use near or around flammable/combustible material or liquids.
- The bulb and fixture can get hot during use. Turn off the power and allow the fixture to cool down before working on the unit.
- When replacing the bulb, use only a Medium Base, Incandescent bulb (100 Watts maximum). Never use a bulb with a higher wattage than the stated maximum wattage allowed on the fixture. Using a higher wattage bulb may cause a fire hazard and/or cause damage to the unit.

WHAT YOU WILL NEED:

- Screwdriver
- Silicone Sealant or Caulk
- Medium Base, Incandescent Lamp Bulb (100 Watts Maximum)

THIS PRODUCT MUST BE INSTALLED IN ACCORDANCE WITH THE APPLICABLE INSTALLATION CODE BY A PERSON FAMILIAR WITH THE CONSTRUCTION AND OPERATION OF THE PRODUCT AND THE HAZARDS INVOLVED.

PREPARING THE FIXTURE FOR INSTALLATION

1. Remove fixture from the packaging.
2. Remove any cardboard or plastic bags from inside lantern.

INSTALLATION

1. Make absolutely sure that all power to the circuit has been shut OFF. Consult a qualified electrician if you are not sure of the installation. Do not use the wall switch as a breaker, because some switches may only be switching the Neutral line.
2. This product should be mounted to a grounded junction box. If a junction box is currently not available at the desired location, have a qualified electrician install one. The power to the junction box should be 120V, 60Hz. If not, do not install fixture at this location.
3. If applicable, remove existing fixture.
4. Bring black and white wires out from the junction box. If necessary, take the two long fixture screws and thread the screws BY HAND all the way through the mounting crossbar as shown.
5. Install the mounting crossbar onto the junction box using the two short mounting screws. Make sure the house wires extend over top of mounting crossbar as shown.
6. Using a wire nut, connect black wire from the house to black wire from the fixture. Using a wire nut, connect white wire from the house to white wire from the fixture. Connect green or bare copper ground wire from the house around the green ground screw on the mounting crossbar so that the end of the wire extends past the screw. Using a wire nut, connect free end of ground wire to the green wire from the lamp. If there is not a ground wire at the junction box, connect the fixture ground wire to the ground screw on the mounting crossbar.
7. Place the fixture over the junction box so that the long fixture screws stick out through the base as shown. BY HAND, screw the two decorative nuts onto the screws until the fixture is secure.
8. Apply silicone caulk around the base for a watertight seal.
9. Install a new Medium Base, Incandescent Bulb (100 Watts maximum).
See INSTALLING OR CHANGING THE LAMP BULB for specific instructions.
10. Turn the main power ON and the wall switch ON to supply power to the fixture.
11. Follow the directions under SELECTING THE FUNCTION AND MAKING ADJUSTMENTS to set the operating parameters for the fixture.

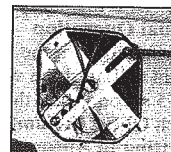
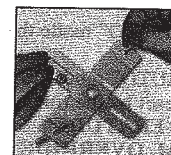

OPTIONAL TORCHIERE (Tail Piece) INSTALLATION

To install the optional, decorative torchiere...

1. Remove the decorative nut from the bottom of the fixture.
2. Replace it with the threaded coupler.
3. Screw the long threaded pipe into the other end of the coupler.
4. Slide the sleeve and the finial halves through the threaded pipe.
5. Hand tighten the decorative nut.

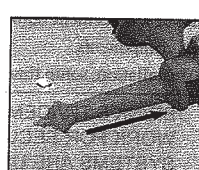
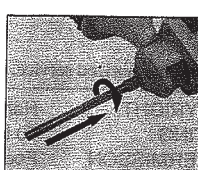
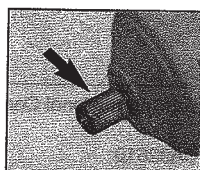

INSTALLING OR CHANGING THE LAMP BULB (bulb not included)

The bulb to be installed should be a Medium Base, Incandescent Bulb (100 Watts maximum).

WARNING

Never use a bulb with a higher wattage than the stated maximum wattage allowed on the fixture. Using a higher wattage bulb may cause a fire hazard and/or cause damage to the unit.

1. MAKE SURE POWER IS OFF. If replacing a bulb, allow the bulb to cool down before handling.
2. Remove the Lantern Cover by unscrewing the two decorative nuts.
3. Unscrew the old bulb by turning counterclockwise.
4. Screw in the new bulb until firmly seated.
5. Position the Lantern Cover back onto the screws and secure in place using the two decorative nuts.
6. Turn the main power and the wall switch ON to supply power to the unit.

SELECTING THE FUNCTION AND MAKING ADJUSTMENTS**PUSH-BUTTON FEATURE CONTROLS (Picture A):**

The two push buttons underneath the base of the fixture controls the Sensitivity (SENS) and Time (TIME).

SENS (Sensitivity) - Sets the sensitivity of the motion sensor. Generally, the sensitivity should be set at maximum. Lower the sensitivity to reduce false triggering caused by small pets. To change the sensitivity level, press the "SENS" button repeatedly until the combination of Red and Green LEDs lit corresponds with the desired setting.

TIME (Duration) - Sets how long the light will stay on after motion is detected. To change the time duration, press the "TIME" button repeatedly until the Red and Green LED's lit corresponds with the desired setting. (between 30 seconds to 3 minutes).

Feature Control	Red LED only	Red and Green LED	Green LED only
Sensitivity (SENS)	40 Feet (12 Meters)	25 Feet (7 meters)	10 Feet (3 meters)
Time (TIME)	3 Minutes	1 Minute	30 Seconds

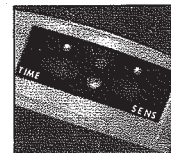

Picture A

MODE Slide Switch (Picture B):**TEST:**

Sliding the switch to "TEST" will allow you to test the area of coverage day or night. This motion detector is most sensitive to movement across its field of detection.

- To test the detection coverage, move the switch to "TEST".
- Walk across the motion detector's field of view until the light turns ON. Stop your movement and wait. The light should turn OFF.
- Wait 8 - 10 seconds. Again walk in the detection area until the lamp turns back ON. Repeat this step as necessary to determine the area covered. Adjust Sensitivity (SENS) as needed (see table above).

PHOTO:

In "PHOTO" mode the light will automatically turn ON at dusk. The light will remain ON and will automatically turn OFF at dawn.

AUTO:

In "AUTO" mode the light will only activate when motion is detected after dusk. The light will remain ON for the time duration as preset by the time (TIME) control (see table above).



Picture B

OTHER FEATURES**MANUAL OVERRIDE FEATURE**

If the security floodlight is connected to a wall switch, the Manual Override Feature is available. The Manual Override Feature allows the unit to be turned ON or OFF manually, bypassing the motion sensor. The Manual Override feature will work only at night.

Manual Operation

To manually turn the floodlight ON, turn the wall switch OFF and then ON again immediately within 2 seconds. The floodlights will turn ON and switch remain ON until the wall switch is turned OFF or until morning. If the wall switch was previously turned OFF for a period of time, turn the wall ON for at least 5 seconds and then use the OFF - ON procedure above to turn the floodlight ON manually. To manually turn the floodlight OFF, simply turn the wall switch OFF. The unit will not activate as long as the wall switch is in the OFF position.

Resetting to Automatic Operation

To return the security floodlight to automatic operation, turn the wall switch OFF for at least 5 seconds and then turn the switch back ON.

The security floodlight will come ON for the time duration set and then turn OFF. The floodlight will now activate according to the settings on the motion sensor. Leave the wall switch in the ON position to operate the floodlight in automatic mode.

AUTO RESET:

When the constant-on condition terminates at dawn, the unit will turn to Auto mode automatically.

MANUAL RESET:

The constant-on condition can also be terminated by flipping the switch off and on again within 2 seconds.

QUESTIONS

For further assistance or more information, please call 1-800-562-5625, 8 am - 5 pm (Pacific Time), Monday - Friday

LIMITED LIFETIME WARRANTY

This product is warranted to be free from defects in material and workmanship for the life of the product. If a defect in material or workmanship occurs, call 1-800-562-5625 for instructions on how to have the defective product replaced free of charge.

Limitations:

- This warranty only covers Brink's assembled light products and is not extended to other components or equipment that is used in conjunction with the product.
- This warranty is extended to the original purchaser of the product. A purchase receipt or other approved proof of purchase is required before warranty service will be rendered.
- Unauthorized service or modification to this product or any furnished component will void this warranty in its entirety.
- THIS WARRANTY IS EXPRESSLY IN LIEU OF ALL OTHER WARRANTIES, EXPRESSED OR IMPLIED, INCLUDING ANY WARRANTY, REPRESENTATION OR CONDITION OF MERCHANTABILITY OR THAT THE PRODUCTS ARE FIT FOR ANY PARTICULAR PURPOSE OF USE, AND SPECIFICALLY IN LIEU OF ALL SPECIAL, INDIRECT, INCIDENTAL, OR CONSEQUENTIAL DAMAGES (INCLUDING BUT NOT LIMITED TO ANY LOSS OF BUSINESS OR PROFITS, WHETHER OR NOT FORESEEABLE) RESULTING FROM THE USE OF THE PRODUCT OR ARISING OUT OF ANY BREACH OF THIS WARRANTY.
- Some states or provinces do not allow the exclusion of incidental or consequential damages, so the above limitation or exclusion may not apply.
- This warranty gives you specific rights, and you may also have other rights that vary from state to state.

Not covered:

- Lamp Bulb(s)
- Failure of the product as result of an accident, misuse, abuse, negligence, alteration, or faulty installation, or any other failure not relating to faulty material or workmanship.
- Damage caused by separately purchased replacement bulbs.
- Corrosion and discoloration of brass components.
- Reimbursement for inconvenience, installation, setup time, loss of use, or unauthorized service.

For information on a **BRINK'S**
Home Security system
Installation, please call
1-800-847-0689

BRINK'S TRADEMARK & COPYRIGHT
WORK FOR SECURITY LIGHTING
SYSTEMS ARE USED WITH PERMISSION
BRINK'S®

Hampton Products International Corp.
50 Icon
Foothill Ranch, CA92610
1-800-562-5625

Made in China
©2004 HAMPTON PRODUCTS
INTERNATIONAL CORP.
999-00501 REV B 10/04