

Fits doors 1-3/8" (35 mm) to 1-3/4" (45 mm) thick

For questions, call  
1-866-LOCK PRO  
(1-866-562-5776)

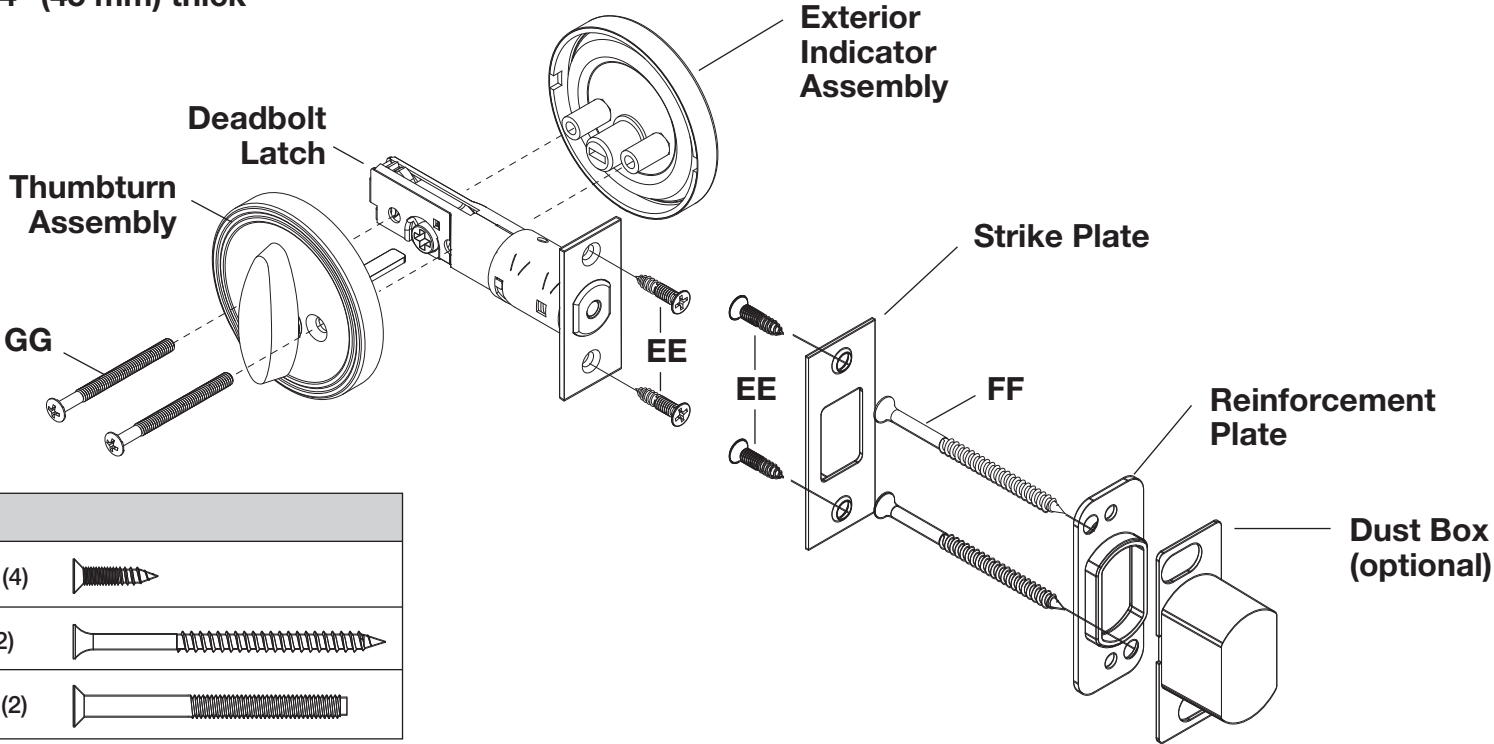

Part	Description
EE	3/4" (19 mm) Latch & Strike Screws (4)
FF	3" (76 mm) Reinforcement Screws (2)
GG	1-15/16" (49 mm) Mounting Screws (2)

For new installations, use the template on the reverse side and proceed to Step 1. For replacement installations, verify the backset and hole dimensions below and go to Step 4.

Tools you will need:

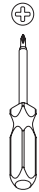

Tools you may need:

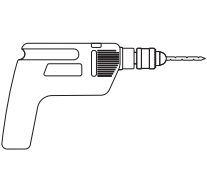
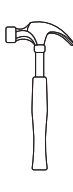
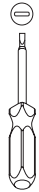

1 Mark Door with Template

- a. Mark the centerline for the deadbolt about 44" (1120 mm) from the floor, or about 5-1/2" (140 mm) above the center of an existing knob or lever.
- b. Apply the template to the door with the dotted fold line on the door edge.
- c. Select the 2-3/8" (60 mm) or 2-3/4" (70 mm) backset and mark the center for the hole for the deadbolt on the door face. (Most residential doors have a 2-3/8" backset.)
- d. Mark the center for the latch hole on the door edge according to the thickness of your door.

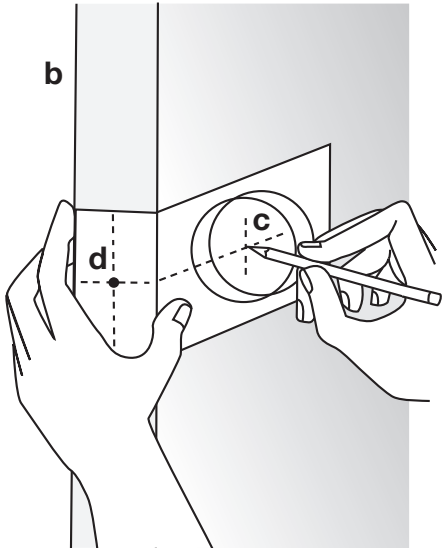
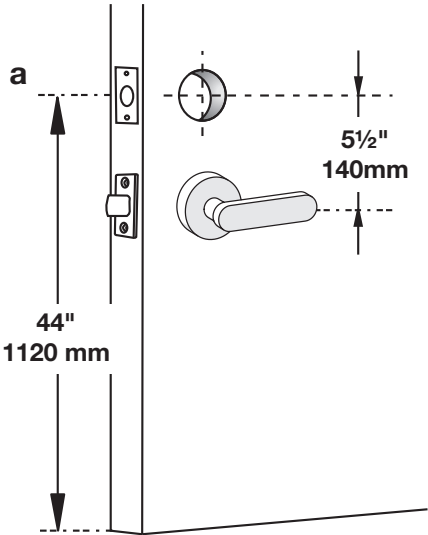

2 Drill Holes

- a. Drill a 2-1/8" (54 mm) hole on the door face from both sides to avoid splitting wood.
- b. Drill a 1" (25.4 mm) hole in the door edge for the latch.
- c. Insert latch into hole, mark outline of faceplate, and chisel 1/8" (3 mm) deep or until the faceplate is flush with the door edge.
- d. Mark latch screw holes and drill two 1/8" (3 mm) pilot holes for the Latch Screws.

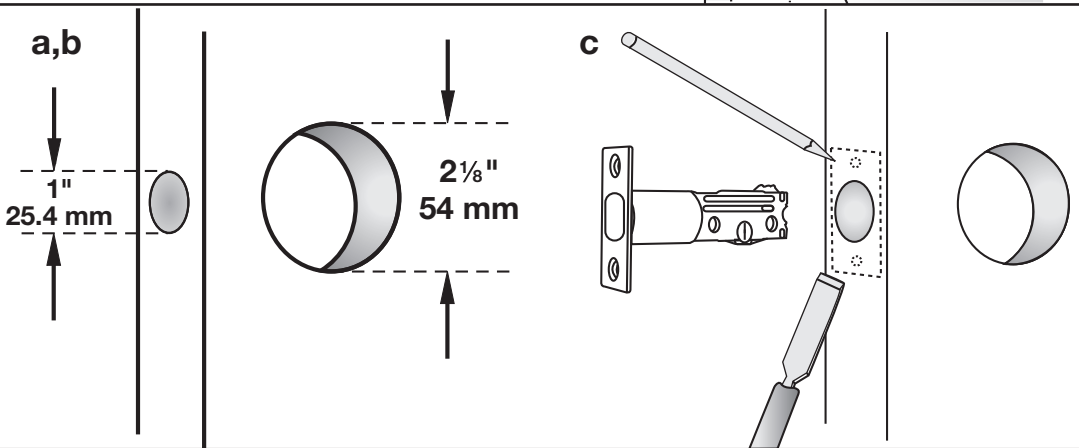

3 Prepare Door Jamb for Strike Plate

- a. Mark centerline on the door jamb exactly opposite the latch hole in the door edge. Make sure that the latch bolt is correct so that the latch bolt will enter the strike plate without interference when the deadbolt is locked.
- b. Using the strike plate as a pattern, drill the latch and screw holes using the dimensions shown. Chisel the mortise deep enough so that the strike and reinforcement plates sit flush with the jamb.

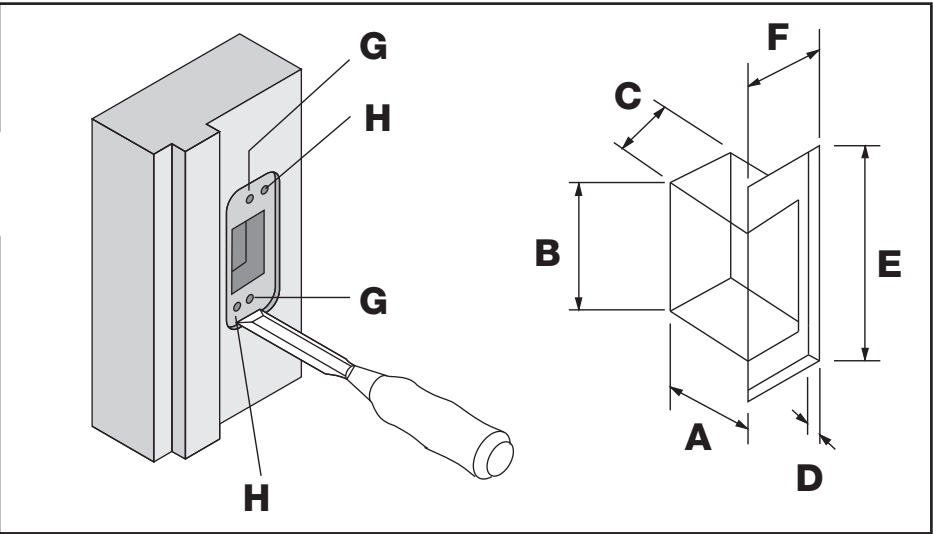
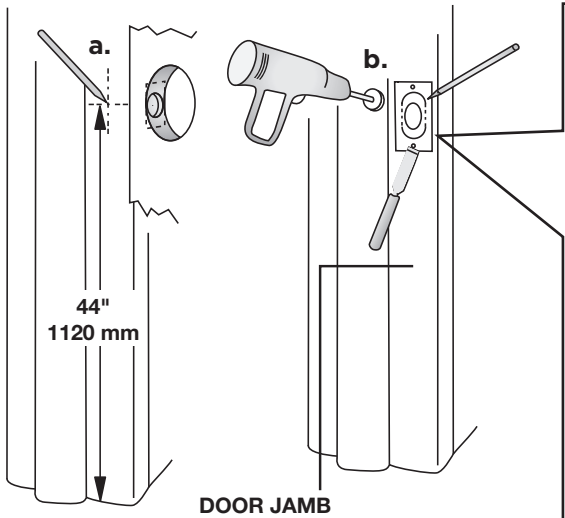

Door Jamb Hole Dimensions

- A. 1-3/16" (30 mm)
- B. 1-9/16" (40 mm)
- C. 1" (25 mm)

Strike Plate Dimensions

- D. 5/32" (4 mm)
- E. 2-3/4" (70 mm)
- F. 1-1/8" (28 mm)

Hole Dimensions

- G. Ø 1/8" (3 mm) x 3/4" (19 mm) Deep
- H. Ø 1/8" (3 mm) x 3" (76 mm) Deep

4

### Set the Latch Backset

- Backset is the distance from the door edge to the center of the hole on the door face. (See illustration.) The latch can be adjusted to fit either a 2-3/8" (60 mm) or a 2-3/4" (70 mm) backset.
- Latch adjustment only needs to be made if your door has a 2-3/8" (60 mm) backset. Otherwise, NO ADJUSTMENT is necessary.
- To adjust your latch to the 2-3/8" (60 mm) backset, hold the back of the latch, and twist the front of the latch one half turn until it stops.
- The latch is now set for the 2-3/8" (60 mm) backset with the 2-3/8" indicated on the latch body as shown.

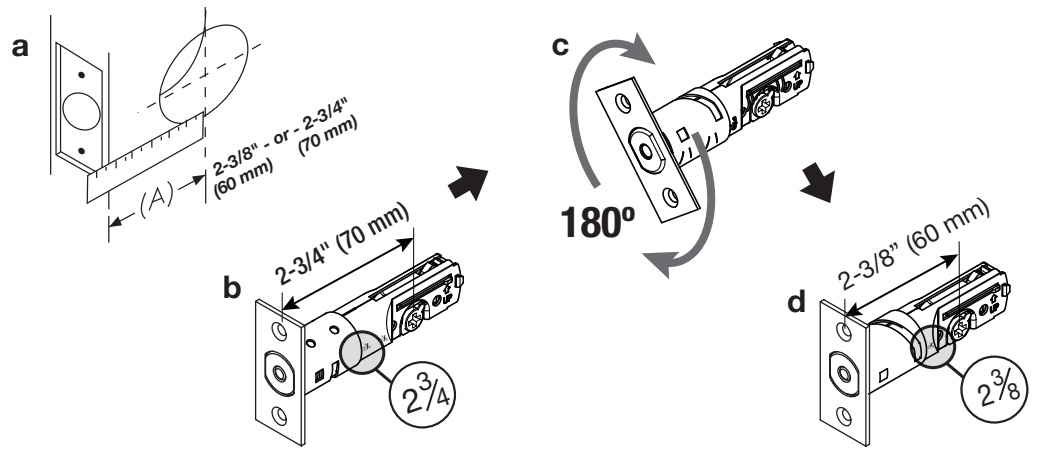

5

### Install the Latch

- Install latch into the 1" hole in the edge of the door in the UP position as marked on the latch with the slotted cam at the bottom.
- Insert two Latch Screws (EE) through the holes in the faceplate and tighten firmly.

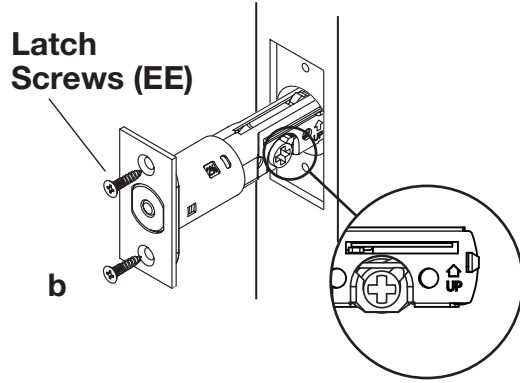

6

### Install Interior Assembly

- Insert the tailpiece of the Interior Assembly through the horizontal slot in the latch cam, and push until the assembly is flush with the inside of the door.

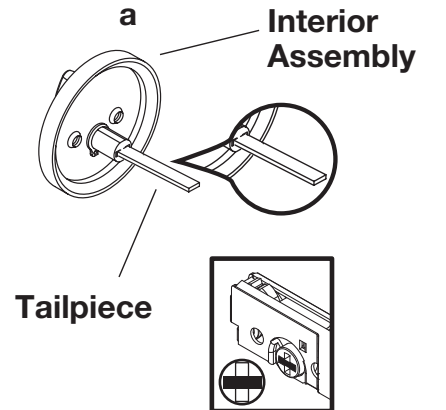

7

### Install Indicator Assembly

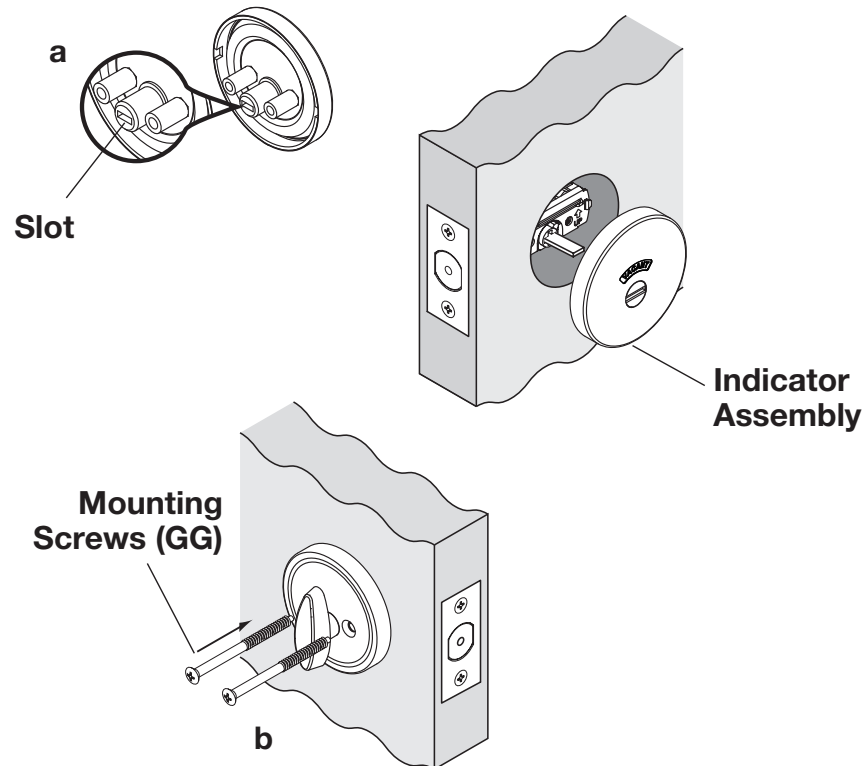

- Align the slot in the Indicator Assembly to the tailpiece of the Interior Assembly and push it against the outside door face.
- Insert two Mounting Screws (GG) through the holes in the Interior Assembly and tighten firmly.

8

### Install Strike Plate

- Insert the Dust Box (optional) and the Reinforcement Plate in the prepared area in the jamb. Insert two Reinforcement Screws (FF) and tighten firmly.
- Place the Strike Plate over the Reinforcement Plate and secure with two Strike Screws (EE). Tighten firmly.

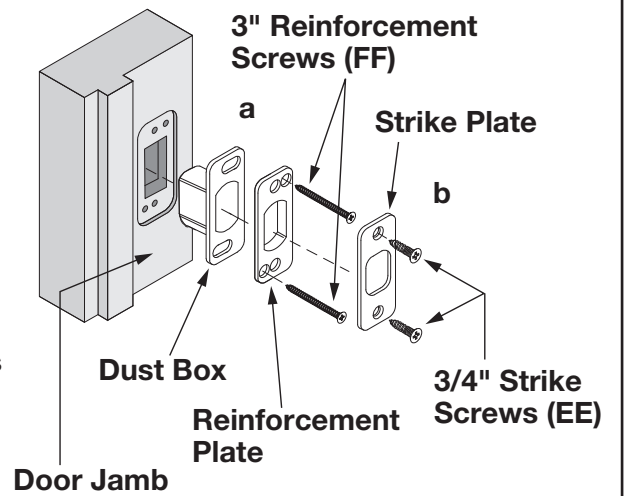

9

### Operation

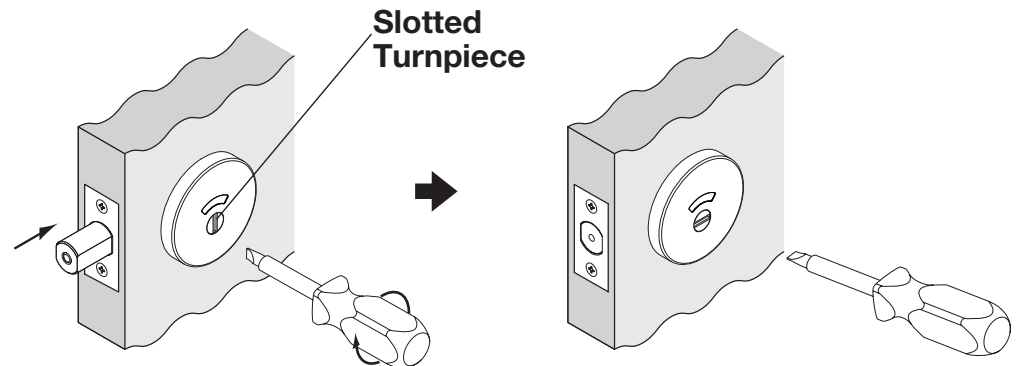

For an emergency situation, the slotted turnpiece in the Indicator Assembly can be rotated using a flathead screwdriver to retract the bolt.

